

版本 Edition	变更内容 Description of the change
C	模板更新

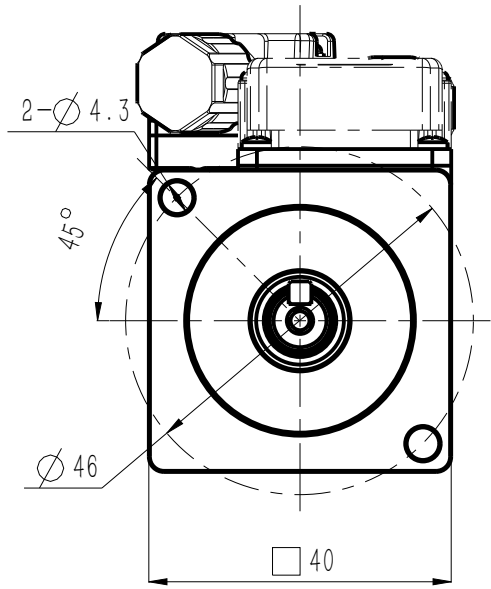
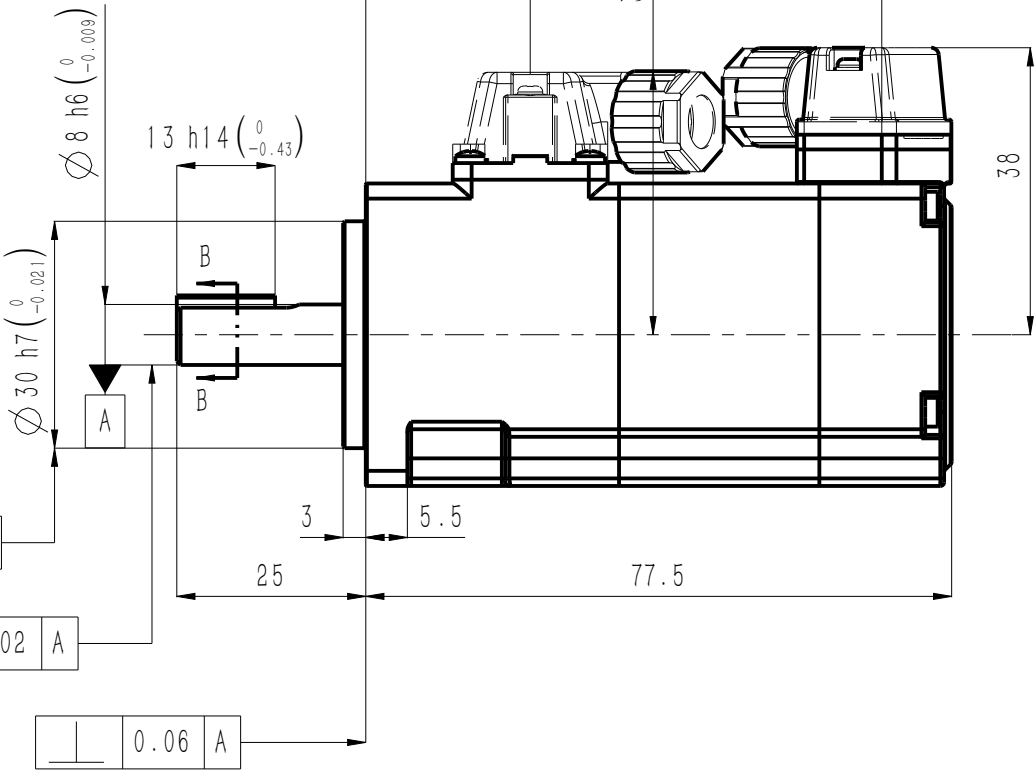
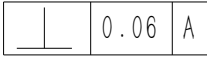
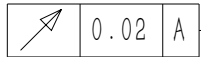
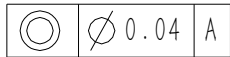
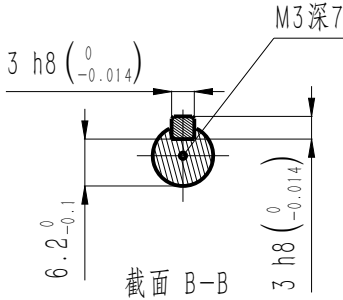
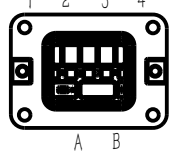
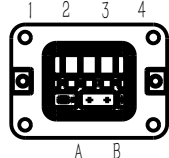

抱闸参数 Brake parameters		
额定电压 Rated voltage	24±10%	V DC
额定功率 Rated power	8	W
电阻(20℃) Resistance	72±7%	Ω
额定扭矩 Rated torque	0.32	N·m
释放电压 Release voltage	>1.5	V
吸引电压 Pickup voltage	<16.8	V
吸合时间 Pickup time	<50	ms
释放时间 Release time	<20	ms
回转间隙 Rotational Clearance	<1° (20%额定扭矩) (20%Rated torque)	

电机技术参数 Motor parameters		
额定电压 Rated voltage	220	V AC
额定功率 Rated power	0.05	kW
额定扭矩 Rated torque	0.16	N·m
峰值扭矩 Peak torque	0.56	N·m
额定电流 Rated current	1.2	Arms
峰值电流 Peak current	5.3	Arms
额定转速 Rated speed	3000	rpm
峰值转速 Maximum speed	7000	rpm
扭矩系数 Torque constant	0.13	N·m/Arms
反电势常数 Back EMF constant	8.6	V/krpm
线电阻 line resistance	7.7	Ω
线电感 line inductance	5.11	mH
转动惯量 Moment of inertia	0.037±10%	kg·cm <sup>2</sup>
轴向允许载荷 Axial allowable load	54	N
径向允许载荷 Radial allowable load	78	N
极对数 Number of pole pairs	5	对
IP防护等级 Ingress Protection Rating	IP67	
绝缘等级 Insulation class	F	
绝缘电阻 Insulation resistance	>100MΩ DC500V	
电机重量 Motor weight	0.4	kg
工作温度 Operating temperature	-20℃~40℃	
工作湿度 Operating humidity	20%~80% (不结露 Non-dewfall)	
推荐安装海拔 Recommend installing altitude	<1000m(1km以上降额使用) (Derate for use above 1km)	

动力端子规格 Power connector	标准款引线定义 Wiring definition without brake					
D 	1	2	3	4	A	B
动力端子规格 Power connector	抱闸款引线定义 Wiring definition with brake					
D 	1	2	3	4	A	B

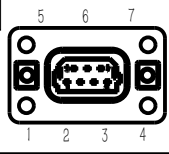
信号端子规格 Encoder connector	编码器规格 Connector specifications	引线定义 Wiring definition						
E 	SC-MC7M-A60G-180 17-bit magnetic encoder 23-bit optical encoder	1	2	3	4	5	6	7
		SD+ (白)	SD- (棕)	BAT+ (蓝)	BAT- (黄)	+5V (红)	0V (黑)	PE (绿)

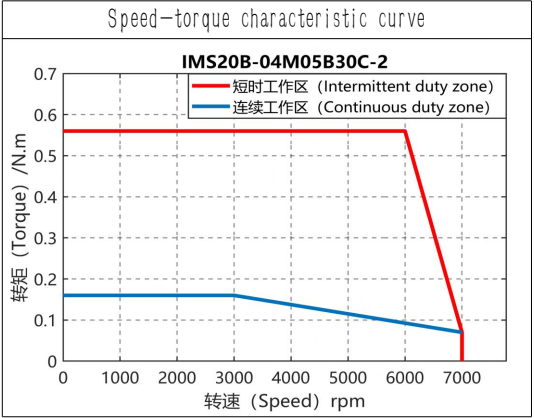
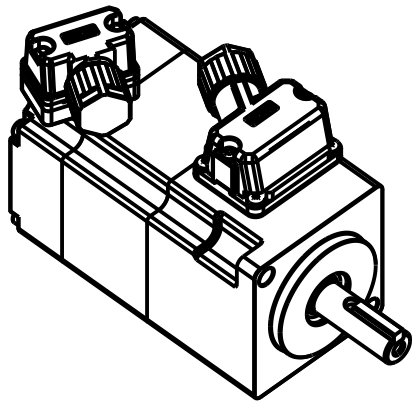

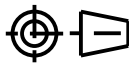
SN	料号 P/N	整机型号 Model and Specification		编码器 Encoder	
1	11101-01614	IMS20B-04M05B30C-2-M45-AUL		17位多圈磁编	
2	11101-01607	IMS20B-04M05B30C-2-P95-AUL		23位多圈光编	
C	替换	/	20260203	名称 电机外形图 Motor outline dimension drawing	
B	新归档	/	20250826		
版本	更改方式	更改人	日期	料号	/
设计	/			图号	/
校核	/			投影标识	
工艺	/			重量	/
审核	/			比例	1:1
标准化	/			第 1 页 共 1 页	
批准	/				